

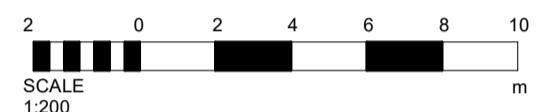

Notes:
 - Do not scale from this drawing. Use figured dimensions in all cases.
 - Verify dimensions on site and report any discrepancies to the Architect immediately.
 - This drawing is to be read in conjunction with the Architect's Specification.
 - © This drawing is copyright and may only be reproduced with the Architect's permission.

Drawing Notes:

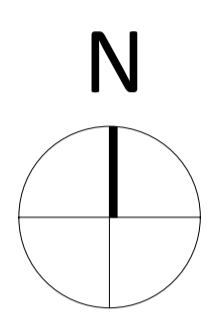
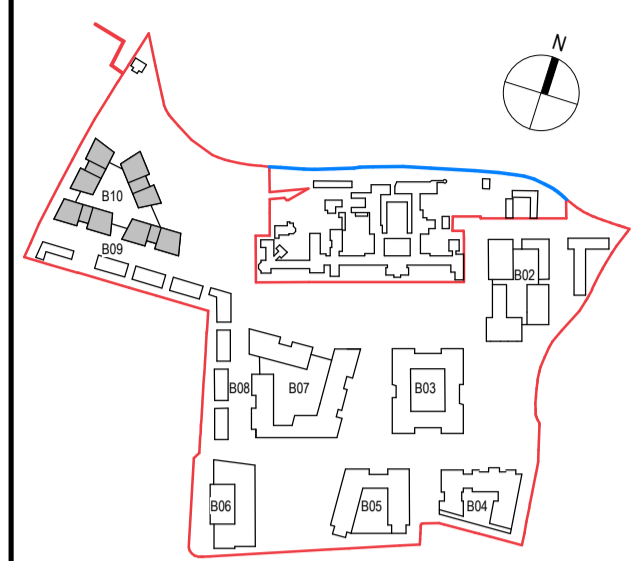

Planning Legend

- Site Boundary
- Residential Entrance
- Service Entrance
- Creche Entrance
- 1B1P Studio Apartment
- 1B2P 1 Bed Apartment
- 2B4P 2 Bed Apartment (4 Person)
- 3B5P 3 Bed Apartment
- Parking Parking
- Creche Creche

| Rev. | Date | Drawn | Details of Issue / Revision |
|--------|----------|-------|-----------------------------|
| P03.08 | 23/03/22 | MMS | SHD Planning Application |

Issues & Revisions

Dartry Mills,
Dartry Road
Dublin 6,
D06 Y0E3

T: +353 (0)1 498 7000
W: www.reddyarchitecture.com
E: info@reddyarchitecture.com

Client Details:
Land Development Agency

Project Details:
**Dundrum Central Development
 Dundrum Road
 Dublin 14**

Drawing Title:
Block 10, Third Floor, GA Plan

| | | |
|--------------------------------|-----------------------------------|---------------------------------|
| Job No. P19-233D | Sheet Size A1_Landscape | Scale @A1: 1 : 200 |
| Issue Date: 23/03/22 | Drawn By: M. McGuire | Reviewed By: L. Wynne |

| | |
|---|---|
| Status S3 | Purpose of Issue SHD Planning Application |
| Project-Originator-Zone-Level-Type-Role-Classification-Number DCD-RAU-02-B10_03-DR-A-1103 | Revision P03.08 |